



YOUTH

ROOM 602/604

FOR TEENS GRADES 6-12



CHILDREN

MEET IN EDUCATION BUILDING

FOR CHILDREN AGES 0-5TH GRADE.



JOY CLASS

ROOM 404

FOR THOSE WITH SPECIAL NEEDS

SUNDAY SCHOOL CONTACTS

Adult Sunday School Director:

Raymond Riggan

Children's Minister:

Candace McCall

Youth Minister:

Eric Hudson

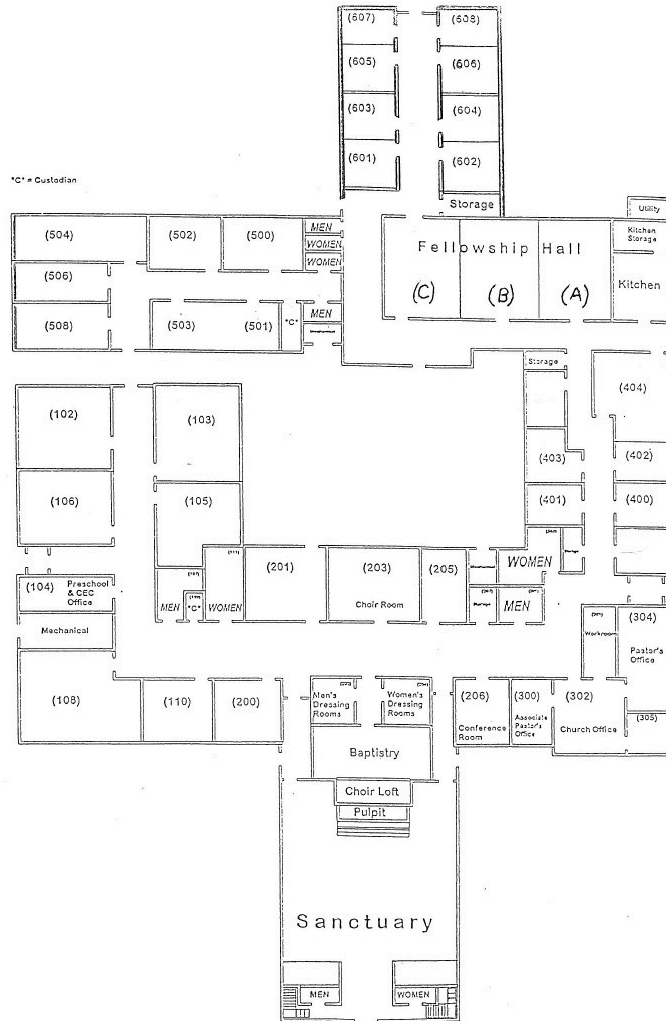

HIGHLAND
BAPTIST CHURCH

SUNDAY SCHOOL

2024-2025





AGAPE

ROOM 103

WE CURRENTLY ARE A SMALL GROUP OF COUPLES AND SINGLES IN OUR 60'S & 70'S, AS WELL AS ONE HONORARY MEMBER IN HIS 90'S! WE WELCOME FOLKS YOUNGER OR OLDER TO JOIN OUR WEEKLY DISCUSSIONS; OUR LESSONS ARE GUIDED BY BARBARA DORMAN AND BILL PACE.



MARGUERITE ROYSTER

ROOM 110

OUR STRUCTURED BIBLE STUDY EACH SUNDAY MORNING IS FOR WOMEN OF ALL AGES AND ALL WALKS OF LIFE. WE ARE A SUPPORTIVE GROUP WHERE ATTENDEES LOVE STUDYING GOD'S WORD WHILE DISCUSSING IT'S MEANING AND EVERYDAY APPLICATION THROUGH SHARED REFLECTION AND PRAYER.



GENESIS

ROOM 506/508

GOD'S CHILDREN STUDYING AND SERVING TOGETHER TO GROW A CLOSER RELATIONSHIP WITH CHRIST. JOIN US AS WE STRIVE TO QUENCH OUR THIRST BY DELVING INTO GOD'S WORD.

AGAPE: GREEK WORD FOR LOVE THAT IS NOT A FEELING BUT AN ACT OF THE WILL, A RESPONSE THAT FLOWS FROM WHAT IS BEST OR NEEDED (I.E. GOD SO LOVED THE WORLD). "AND THIS IS LOVE; THAT WE WALK IN OBEDIENCE TO HIS COMMANDS. AS YOU HAVE HEARD FROM THE BEGINNING, HIS COMMAND IS THAT YOU WALK IN LOVE." II JOHN 1:6 (NIV)



YOUNGER ADULT

ROOM 102

A CLASS FOR COUPLES AND SINGLES IN THEIR 20'S & 30'S

SUNDAY SCHOOL TEACHERS: JASON DUNLAP & COUETNEY GULLEY



PILATHEIA

ROOM 201

WE ARE A SENIOR ADULT SUNDAY SCHOOL CLASS. CLASS MOTTO- "LOVER OF TRUTH" SUNDAY SCHOOL TEACHER - REV. CARLTON MCDANIEL



ABUNDANT LIFE

ROOM 105

ADULTS IN THEIR 60'S AND 70'S. OUR CLASS IS OPEN TO THOSE OF ANY AGE.

LED BY: HUGH CLARK, MAX MILLER, TIM INSCORE & GLEN WALL.



OPEN DOOR

ROOM 501/503

"OPEN DOORS! OPEN ARMS! OPEN HEARTS! OPEN MINDS!" ADULT CLASS AGES 55 AND OVER; SINGLES AND COUPLES.

NOVUM GENUS

ROOM 504

WE ARE A CLASS CONSISTING OF COUPLES & SINGLES IN THEIR 40'S & 50S. WE WELCOME ANYONE OF ANY AGE! OUR STUDIES ARE LED BY JAY STRICKLAND & JAY WALLACE.

